



INDEX C200, VDI30

Tool holder Basic equipment

INDEX C200, VDI30 - Basic Equipment - Tool Holders

We recommend the following basic equipment for tool holders and accessories.

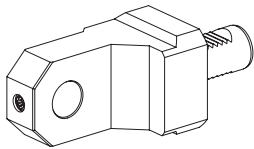

1x Bar stop, live

Part no. 11018887
 Fixation none
 Mounting –
 Cooling –
 X / Y / Z 92 / – / 31 mm

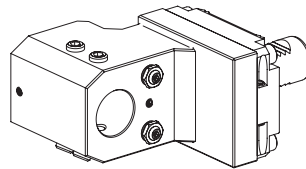

2x Drill holder

Part no. 10092885
 Fixation W-serration
 Mounting DIN 1835 B/E D32
 Cooling external & internal, p_{max} 80 bar
 X / Y / Z 100 / – / – mm

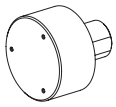

1x Bar stop, live

Part no. 10900227
 Fixation –
 Mounting D58
 Cooling –
 X / Y / Z – / – / 30 mm

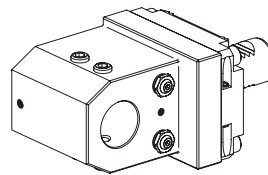

4x Drill holder

Part no. 10941548
 Fixation W-serration
 Mounting DIN 1835 B/E D32
 Cooling external & internal, p_{max} 80 bar
 X / Y / Z 90 / – / 30 mm

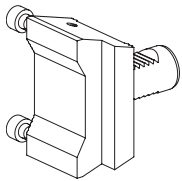

1x Base holder, adjustable

Part no. 10774339
 Fixation W-serration
 Mounting –
 Cooling external, p_{max} 20 bar
 X / Y / Z 38 / – / 32 mm

2x Reduction sleeve D32/06

Part no. 10735500

2x Reduction sleeve D32/10

Part no. 10264567

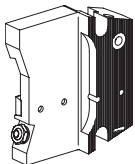

1x Grooving tool holder block

Part no. 10453502
 Fixation –
 Mounting Trapezoidal 32x8
 Cooling external, p_{max} 80 bar
 X / Y / Z 87,5 / – / 20 mm

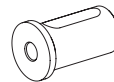

2x Reduction sleeve D32/12

Part no. 10865452

2x Reduction sleeve D32/16

Part no. 10246709

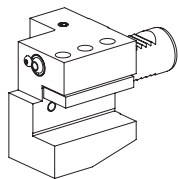

10x Turning tool holder, form C1/C4

Part no. 10663275
 Fixation none
 Mounting Square 25x25
 Cooling external, p_{max} 40 bar
 X / Y / Z 70 / – / 40 mm

2x Reduction sleeve D32/20

Part no. 10787586

2x Reduction sleeve D32/25

Part no. 10626419

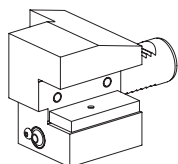

6x Turning tool holder, form C2/C3

Part no. 10719601
 Fixation none
 Mounting Square 25x25
 Cooling external, p_{max} 40 bar
 X / Y / Z 70 / – / 46 mm

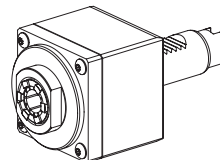

4x Milling unit

Part no. 10692074
 Fixation none
 Mounting ER 25
 Cooling external, p_{max} 80 bar
 Transmission ratio 1:1 (1)
 X / Y / Z 81 / – / – mm

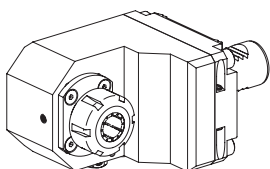

4x Drill holder

Part no. 10192281
 Fixation W-serration
 Mounting ER 25
 Cooling external & internal, p_{max} 80 bar
 X / Y / Z 90 / – / 29 mm

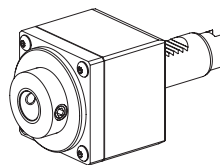

3x Milling unit

Part no. 10657344
 Fixation none
 Mounting DIN 1835 B/E D20
 Cooling external, p_{max} 80 bar
 Transmission ratio 1:1 (1)
 X / Y / Z 86.5 / – / – mm

INDEX C200, VDI30 - Basic Equipment - Tool Holders

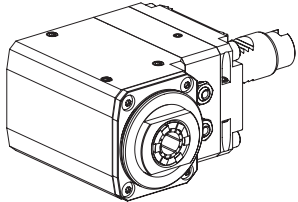

4x Milling unit

Part no. 10571448
 Fixation W-serration
 Mounting ER 25
 Cooling external, opt. internal, p_{max} 80 bar
 Transmission ratio 1:1 (1)
 X / Y / Z 90 / - / 84 mm

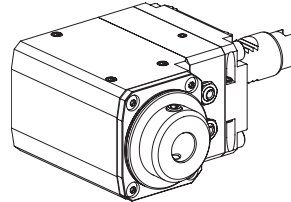

1x Milling unit

Part no. 10202810
 Fixation W-serration
 Mounting DIN 1835 B/E D20
 Cooling external, opt. internal, p_{max} 80 bar
 Transmission ratio 1:1 (1)
 X / Y / Z 90 / - / 93 mm

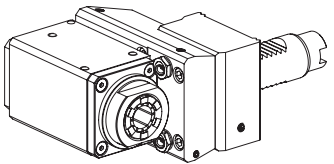

2x Milling unit

Part no. 10005333
 Fixation W-serration
 Mounting ER 25
 Cooling external, opt. internal, p_{max} 80 bar
 Transmission ratio 1:1 (1)
 X / Y / Z 90 / - / 22 mm

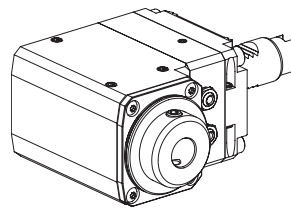

1x Milling unit

Part no. 10011322
 Fixation W-serration
 Mounting DIN 1835 B/E D20
 Cooling external, opt. internal, p_{max} 80 bar
 Transmission ratio 2:1 (2)
 X / Y / Z 90 / - / 93 mm

We will be happy to expand the listed basic equipment tailored to your production requirements.

Please keep in mind that machine-specific and material-specific components, such as clamping devices, spindle reductions and accessories are also needed for the bar loading magazine.

INDEX C200, VDI30 - Basic Equipment - Machine Accessories

For best operation of your machine, INDEX offers tailor-made spindle reducers and clamping devices.

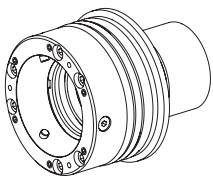

Main spindle D65

HAINBUCH Spanntop nova modular - through-bore chuck
 Part no. 10182829

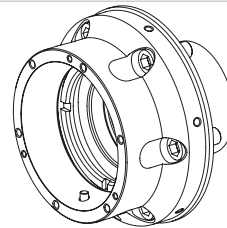

Main-/Counter spindle D90

HAINBUCH Spanntop nova modular - through-bore chuck
 Part no. 10643312

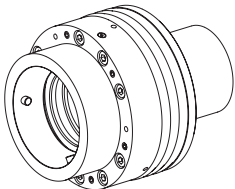

Counter spindle D65

HAINBUCH Spanntop nova combi deadlength with end-stop
 Part no. 10916697

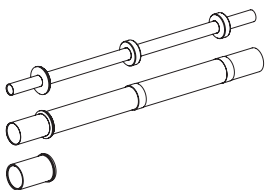

Spindle diameter 65mm, Clamping stroke independent
 Material diameter D5 - D66
 Please note the part no. from the Spindle Reductions section under infoshop.index-werke.de

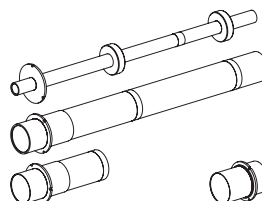

Spindle diameter 90mm, Clamping stroke 10mm
 Material diameter D8 - D90
 Please note the part no. from the Spindle Reductions section under infoshop.index-werke.de

We will be happy to send you an individual offer. Simply give us a call at +49 711 3191-9854 or send us an e-mail to werkzeughalter@index-werke.de

In addition, INDEX also provides presetting adapters, mounting aids for damage-free installation, and gauging your tool holders and other accessories.

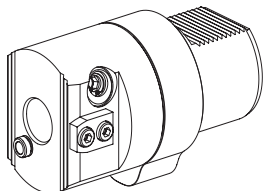

**Presetting adapter
VDI80**

Tool mounting VDI30
Part no. 10864045

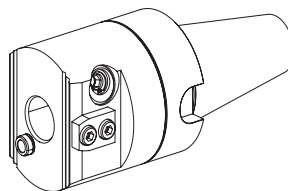

**Presetting adapter
quick-release taper 50**

Tool mounting VDI30
Part no. 10740620

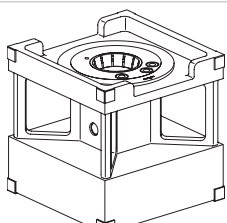

Pre-adjustment block

Basic body
Part no. 10444808

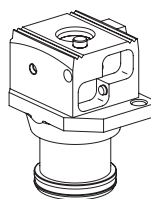

Pre-adjustment block

Adapter tool mounting VDI30
Part no. 10300226

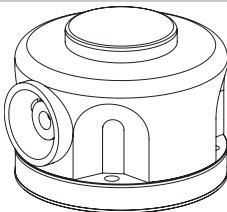

Mounting aid TOOLFIX

Base body
Part no. 10917422

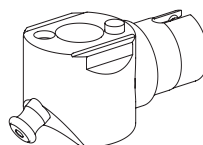

Mounting aid TOOLFIX

Adapter tool mounting VDI30
Part no. 10127253

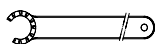

Chuck Key

Type E25AX
Part no. 10179444



Chuck Key

Type ER25
Part no. 10802433

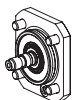

IC-attachment

up to 80bar
Part no. 10687215

For more information, visit our Infoshop at infoshop.index-werke.de

INDEX-Werke GmbH & Co. KG
Hahn & Tessky

Plochinger Straße 92
D-73730 Esslingen

Fon +49 711 3191-0
Fax +49 711 3191-587

info@index-werke.de
www.index-werke.de